

FI GS Vandal Resistant

Highly robust for maximum wear-resistance

Benefits at a glance

- Vandal resistant, certified according to EN81-71 Class 2
- Long-lasting and highly wear-resistant
- Elegant design
- User-friendly handling and clear indications
- Fast installation
- Compliance with latest EU norms and regulations

Designed for rough conditions

Car operating panels and landing control stations in elevators often have to withstand rough treatment and handling, especially in unattended locations, such as public buildings, railway stations or freight elevators.

That is why we have developed the Schindler FI GS Vandal Resistant car operating panel and landing control stations. They are designed extremely robust to resist very high temperatures as well as rough impacts and allows for a long service life.

Special construction

The FI GS Vandal Resistant car operating panels and landing control stations are built to cover the latest EU norms and regulations to avoid incorrect usage:

- They are let into the wall and so are flush with the surface
- No visible means of attachment
- They can only be opened using special tools
- All numbers and letters are particularly robust
- The function of the buttons cannot be impaired
- The panels are shock and fire tested according to EN 81-72 class 2

Full FI GS functionalities

The Schindler FI GS Vandal Resistant aligns with all FI GS standard functionalities. It has an elegant and user-friendly design for a highly reliable, clear and straightforward communication. Optionally, it can be equipped with Braille script or with a microphone and loudspeaker for a 24 hour dedicated emergency line to meet all safety regulations for existing systems. To keep you always informed about the current status of your elevator single LEDs are used for alarms and notifications.

Landing Indicator Panel



Landing Operating Panel



Car Operating Panel

KT
Kits

AC
Accessories

CW
Counter-weights

SA
Safeties

FI
Fixtures

CA
Cars

DO
Doors

MM
Mechanical material

CO
Controls

DR
Drives



Fast installation

Quick and easy to install on door frames and car walls, the Schindler FI GS Vandal Resistant features adapter plates in various dimensions to cover existing cut-outs. It is mounted flush on the wall to minimize the contact surface towards passengers. An ideal way to keep building adaptations to a minimum.



Tested according to EN81-72 Class 2 fire resistance requirements

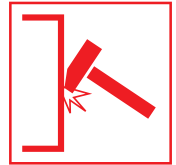

Tested according to EN81-71 Class 2 pressure resistant requirements



Car Operating Panel (COP)
 – Position and direction indicator
 – Single LEDs for alarms & notifications
 – Emergency light
 – Flexible button positioning

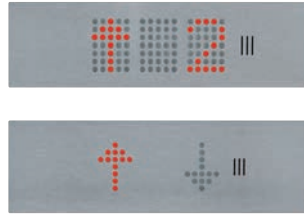

Landing Indicator Panel (LIP)
 – Position and direction indicator
 – Landing gong

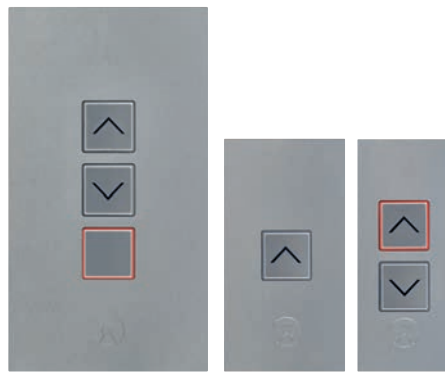

Landing Operating Panel (LOP)
 – Red confirmation light
 – Adapter plates
 – Alarm & notification lamps

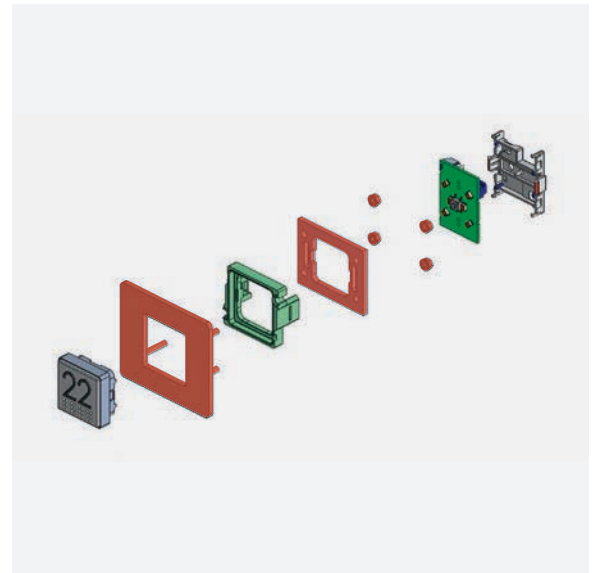

Mechanical push button
 – Reinforced construction

Technical data

Construction	3mm stainless steel front, fixed by invisible clips
Finishing	stainless steel brushed
Dimension	Short and full-height
Fixing	flush mount, hidden means of attachment
Position indicator plate	programmable red LED dot matrix, perforated stainless steel
Elements	Square stainless steel button, LED illuminated red confirmation border
Regulation	Certified according strongest EN81-72 class 2

FI GS Vandal Resistant – Built to withstand the roughest conditions

Our specialists are looking forward to advising you on the optimum solution for your particular needs.